

FOR IMMEDIATE RELEASE

**\*\*UPDATE\*\***

### Lane Shift on Westbound Foothill Freeway I-210 For Pavement Rehabilitation

Pasadena and La Cañada Flintridge – Beginning the week of August 21, the California Department of Transportation (Caltrans) will make temporary changes along westbound Foothill Freeway (I-210) from Lincoln Avenue to Foothill Boulevard. Construction crews will restripe and shift lanes towards the median.

Both eastbound and westbound inner shoulders will be used as traffic lanes. The eastbound inner shoulder will become a temporary bypass lane for westbound traffic. A concrete barrier will separate the eastbound traffic and the westbound bypass lane for the safety of motorists. Two outer lanes on westbound I-210 will close as crews begin to replace the pavement along the freeway. The bypass lane allows all traffic lanes on westbound I-210 to remain open while work is underway, which will be in effect through spring 2018.

The Foothill Freeway is a major thoroughfare, serving commuters between Los Angeles and San Bernardino counties. As a result of heavy use, the road needs to be replaced with new pavement. The temporary traffic lane shift and closures are part of a \$148.5 million pavement rehabilitation project on I-210. Once the project is completed in 2018, the new surface will provide a smoother drive for motorists, reduce time required for maintenance, and minimize the need for further lane closures. Motorists are advised to “Be Work Zone Alert.”

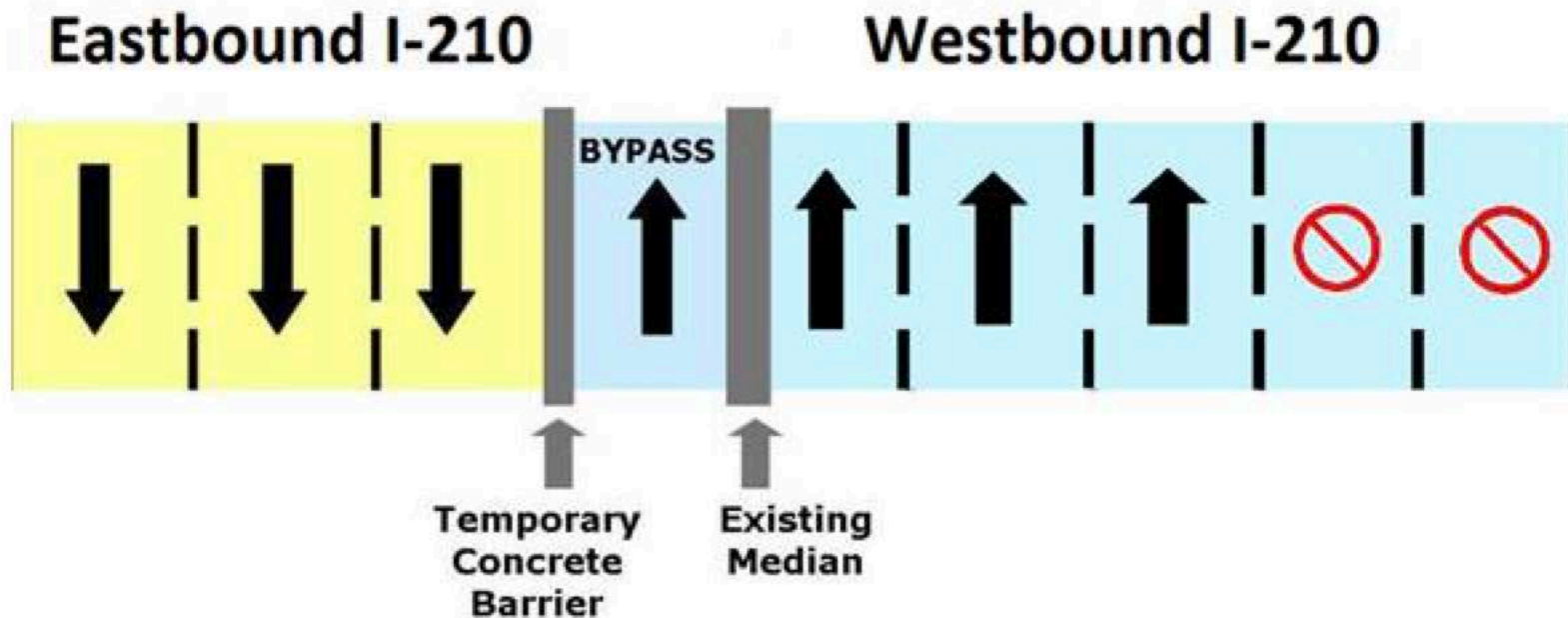



# Caltrans Construction Notice

## Foothill Freeway (I-210) Long-Term Closures

### WHAT

The California Department of Transportation (Caltrans) will close **one lane** of the eastbound Foothill Freeway (I-210) from Ocean View Boulevard to Lincoln Avenue as part of a pavement rehabilitation project. The lane closure is necessary as crews begin to replace damaged pavement along the freeway.

Along with the lane closure, long-term ramp closures will be taking place:

- **Eastbound I-210 Berkshire Place on-ramp and Arroyo Boulevard off-ramp will be closed**
- **Westbound I-210 Ocean View Boulevard on-ramp and La Crescenta Avenue off-ramp will be closed**

### WHEN

- The eastbound I-210 lane closure will begin April 17, and will remain in effect through winter 2017
- Ramp closures on westbound I-210 will begin April 11 through June 2017
- Ramp closures on eastbound I-210 will begin April 24 through June 2017

### WHY

The closures are part of \$148.5 million pavement rehabilitation project in both directions of I-210 in the cities of Glendale, La Canada Flintridge, and Pasadena. Once the project is completed in 2018, the new surface will provide a smoother drive for motorists, reduce time required for maintenance, and minimize the need for further lane closures.

### WHAT TO EXPECT

Detour signs will be posted. Motorists should expect delays, are advised to consider alternate routes, and check traffic conditions before traveling. Caltrans reminds you to "Be Work Zone Alert"

**BE WORK  
ZONE ALERT**  
CALTRANS

For real time freeway traffic information,  
please visit the Caltrans Quickmap, <http://quickmap.dot.ca.gov>  
For additional information please contact Karina Vargas at (213) 897-7602 or  
[karina.vargas@dot.ca.gov](mailto:karina.vargas@dot.ca.gov)  
Twitter: @CaltransDist7

